

GROUND FLOOR
574 sq.ft. (53.3 sq.m.) approx.

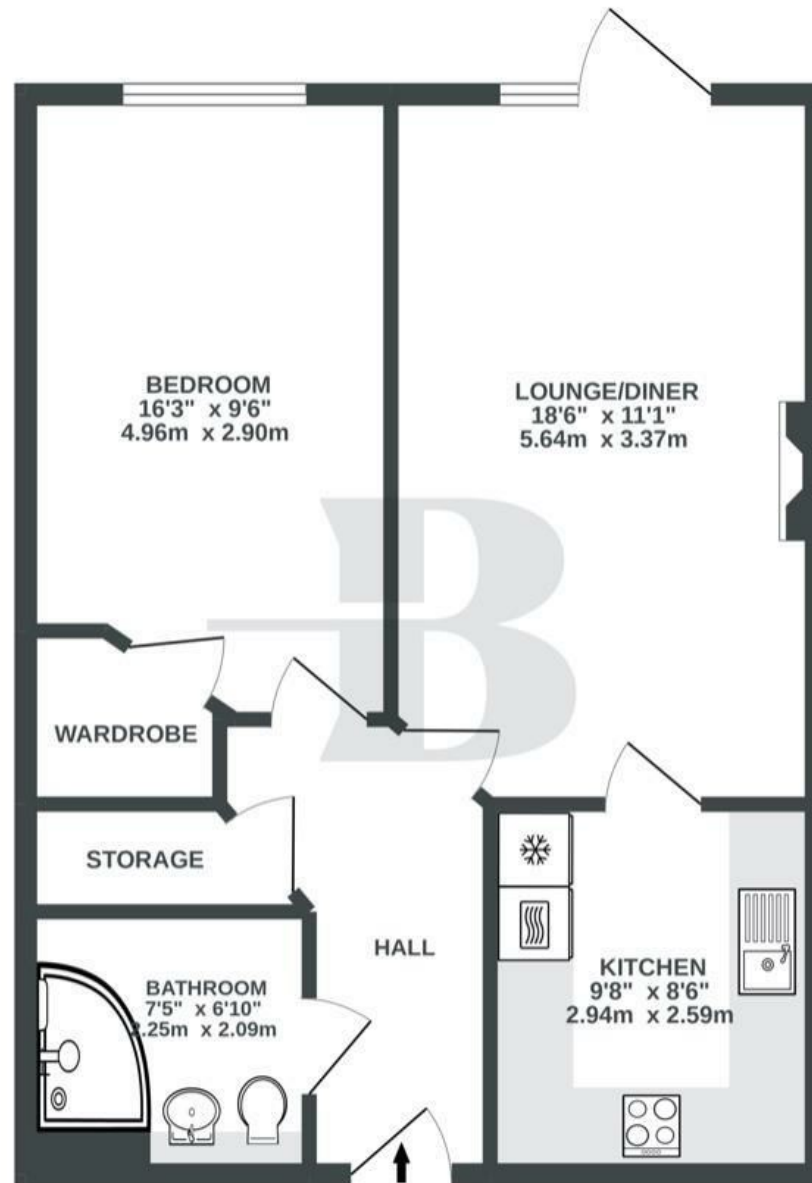

TOTAL FLOOR AREA : 574 sq.ft. (53.3 sq.m.) approx.

Whilst every attempt has been made to ensure the accuracy of the floorplan contained here, measurements of doors, windows, rooms and any other items are approximate and no responsibility is taken for any error, omission or mis-statement. This plan is for illustrative purposes only and should be used as such by any prospective purchaser. The services, systems and appliances shown have not been tested and no guarantee as to their operability or efficiency can be given.
Made with Metropix ©2022



Boardwalk

Normandy Drive

YATE, BRISTOL



£250,000



1 Bedrooms



Bristol, BS37

4FX



1 Bathrooms

'My mum loved living in Trewin Lodge, it has such a great community spirit, the other apartment owners are so friendly, and meet up regularly for coffee and cake mornings in the communal lounge. Day trips are available regularly too, should you wish to participate

'When you live at Trewin Lodge, you have the very best of both worlds, you have your own independent living apartment, but you feel safe in the knowledge that the Lodge Manager is on hand should you need them.'

